

DRAWN BY CADD
DO NOT AMEND MANUALLY

TCS 0149

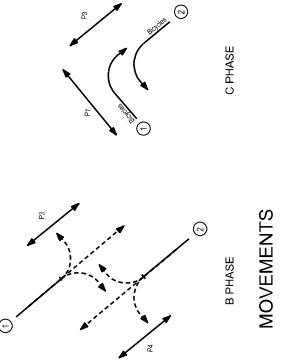

SIGNAL GROUP / PHASE CHART

SIGNAL GROUP	SIGNAL PHASE DURING WHICH GREEN DISPLAYED			REMARKS
	A	B	C	
V1	C			Timed protection for P1 & P2 PED. XS-F1 disables protection.
V2	C			Timed protection for P1 & P2 PED. XS-F1 disables protection.
V3	C			Timed protection for P3 & P4 PED. XS-F2 disables protection.
V4	C			Timed protection for P3 & P4 PED. XS-F2 disables protection.
V5		X		
V6		X		
P1	X			Automatic introduction subject to the presence of XSF 11 bit.
P2	X			Automatic introduction subject to the presence of XSF 12 bit.
P3		X		Automatic introduction subject to the presence of XSF 13 bit.
P4		X		Automatic introduction subject to the presence of XSF 14 bit.

POSTS

POST TYPE	LENGTH	OFFSET	REMARKS	MGA CO-ORDINATES	
				EASTING	NORTHING
1	2	4.1	1,0 New	3324664551	6248731477
2	2	4.1	1,1 Existing	-	-
3	2	4.1	2,0 New	332478.636	6248752.518
4	2	4.1	1,0 Existing	-	-
5	2	4.1	1,0 Existing	-	-
6	2	4.1	1,0 Existing	-	-
7	2	4.1	1,0 Existing	-	-
8	2	4.1	1,0 New	332478.270	6248722.610

DETECTOR SPECIFICATION

Detector	Specifications		
	FN (A/U)	AE(I)	BU
A1	SGPS A	A	A (PI/WALK)
	DS	-	B
A2	FN A(U)	AE(Z)	BU
	SGPS A	A	A (PI/WALK)
	DS	-	B
B1	FN B(U)	BE(I)	BU
	SGPS B	B	B (PI/WALK)
	DS	-	A
B2	FN B(U)	BE(Z)	BU
	SGPS B	B	B (PI/WALK)
	DS	-	A
C1	FN C(U)	CE(I)	BU
Bicycle	SGPS C	C	C (PI/WALK)
	DS	-	A
C2	FN C(U)	CE(Z)	BU
Bicycle	SGPS C	C	C (PI/WALK)
	DS	-	A

DETECTOR SPEC. CONT.

Detector	Specifications		
	FN (A/U)	AN(P)	BU
P1	SGPS P1(WALK)	A	A (PI/WALK)
P.B.	DS	-	B
P2	FN P2(WALK)	A	BU
P.B.	SGPS P2(WALK)	A	A (PI/WALK)
	DS	-	B
P3	FN P3(WALK)	BI(E)	BU
P.B.	SGPS P3(WALK)	B	B (PI/WALK)
	DS	-	A
P4	FN P4(WALK)	BI(Z)	BU
P.B.	SGPS P4(WALK)	B	B (PI/WALK)
	DS	-	A

- NOTES**
- This site is SCATS linked.
 - SCATS cycle detectors are provided on posts 3 and 7.
 - Audio tactile push buttons are provided on all posts.
 - Bicycle lanterns on posts 1, 4, and 6 mounted beneath vehicle lanterns at a minimum height of 2.4m above the footpath.
 - Bicycle lanterns 200mm with square visors and no target band.
 - Trees to be regularly inspected and trimmed by Council to maintain lantern visibility.
 - Where necessary, bicycle lanterns to be installed in accordance with City of Sydney guidelines.
 - Where necessary, bicycle lanterns to be installed in accordance with City of Sydney Technical Specification drawing number 1.1.1.
 - Bicycle Detectors to be installed in accordance with TINSW Drawings VC005-36A and VC005-38A.
 - Chill road works in accordance with AECOM drawing set drawing set 60920833-2/C.
 - Automatic introduction of bicycle Phase (C Phase) subject to XSF 15.
 - Automatic introduction of bicycle Phase (B Phase) subject to XSF 16.
 - Bus stop duplicated to Sydney Park Road.
 - Two additional arrows.

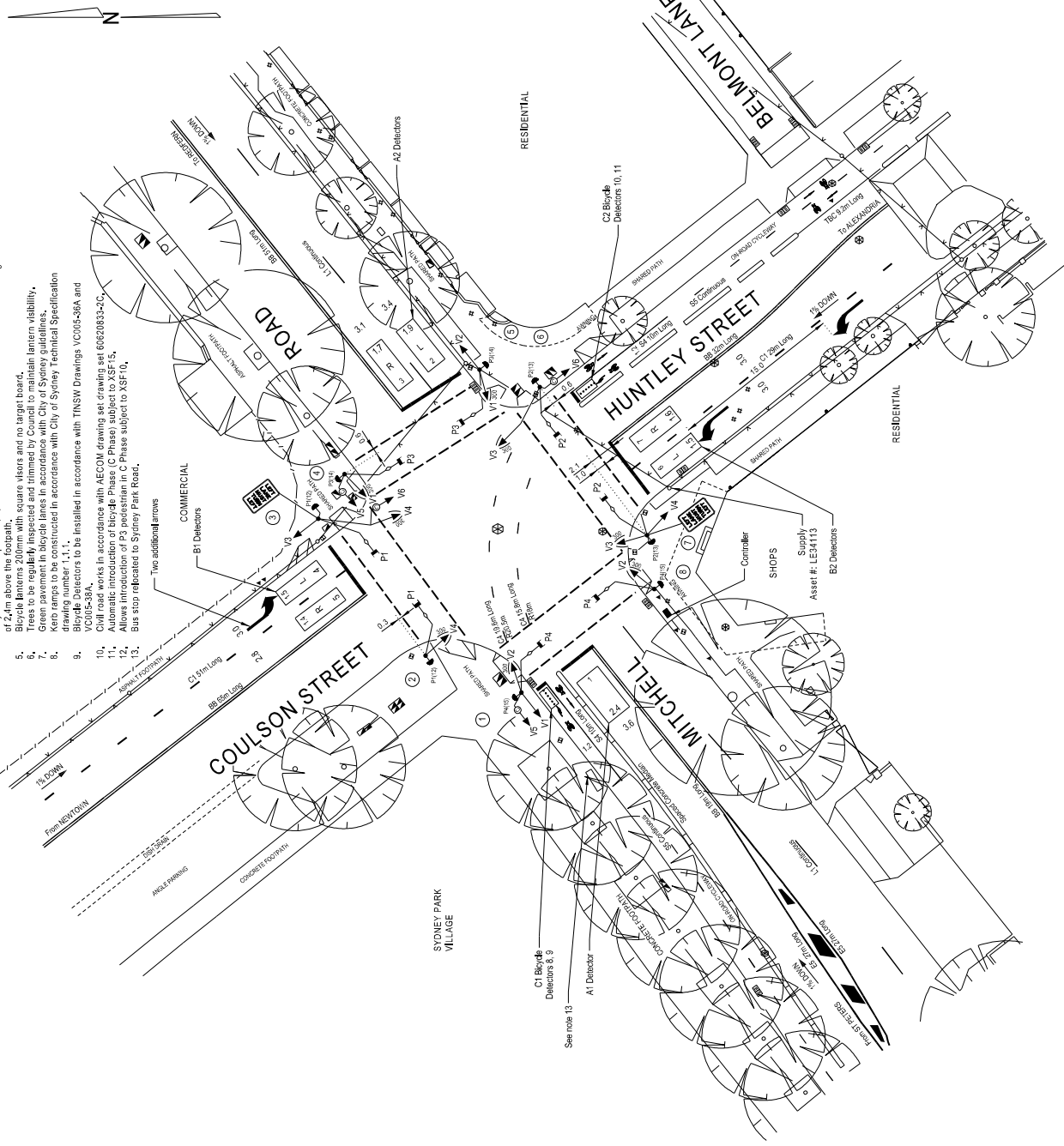

TRANSPORT FOR NSW		CADD FILE: V:\V0163_A_Design		PROPOSED	EXISTING	
SYDNEY COUNCIL AREA		SCALE: 1:12000		TCS No. DS2013/001784		
TRAFFIC SIGNALS AT		FILE: SF2013/69236		SHEET: 5K		
MITCHELL ROAD, COULSON STREET		REG No.		TCS No. 0149		
AND HUNTLEY STREET		DESIGN LAYOUT		SHEET 8		
ERSKINEVILLE		PROJECT No.		REVISION 1 - 08/02/09		

DESIGN APPROVAL	DESIGNER	DATE	DESIGN CHECKED	DATE
<input type="checkbox"/>	AECOM			

TINSW RECOMMENDATION	DATE	REVISION
<input type="checkbox"/>		

TINSW ACCEPTANCE	DATE	REVISION
<input type="checkbox"/>		

LEGEND

- EXTENT OF WORKS
- SHEET BOUNDARY

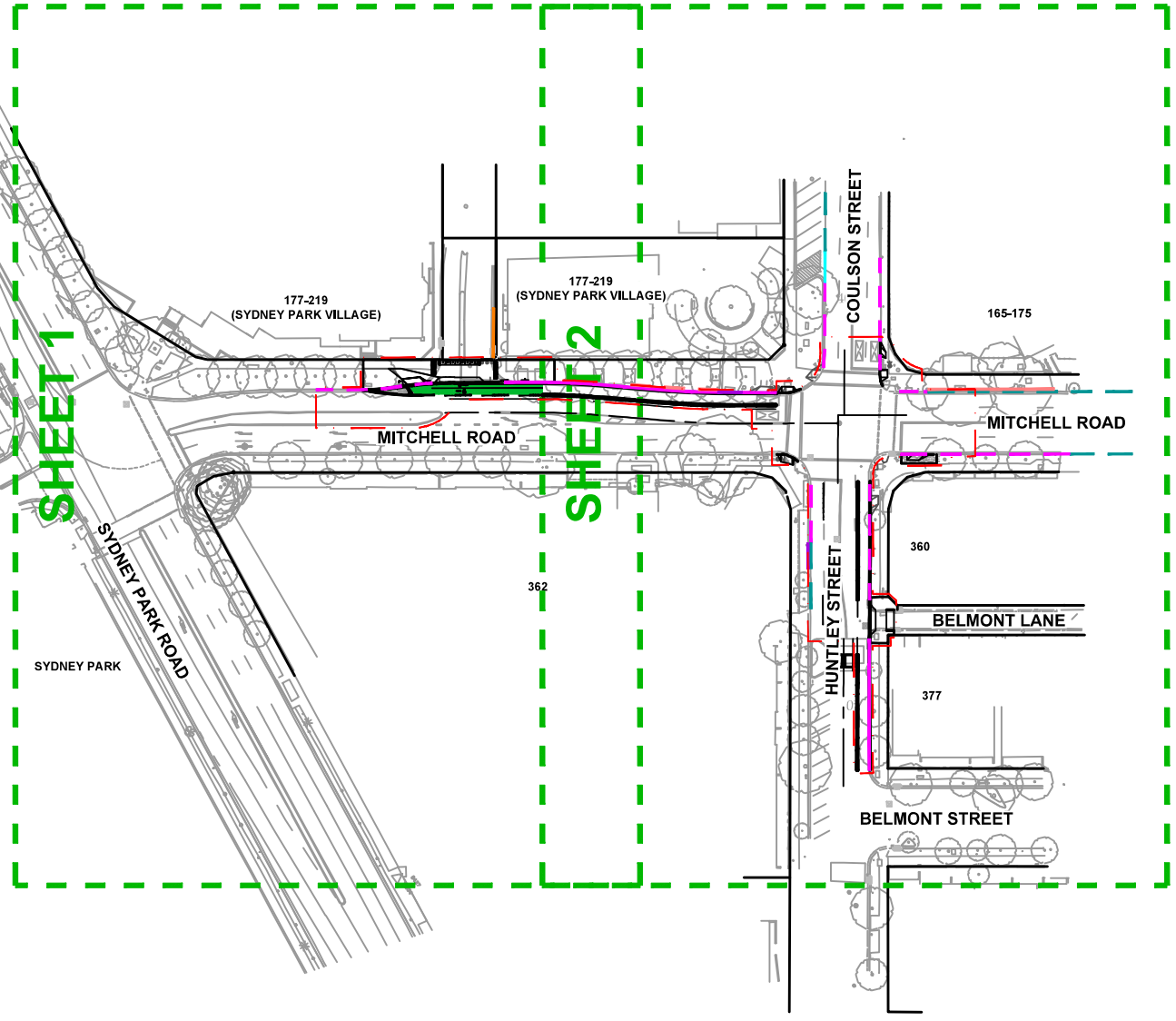
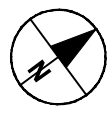

0 50 100 m
1:1000
FOR INFORMATION



LEGEND	
	SHARED PATH LINEMARKING
	NO STOPPING (Existing)
	NO STOPPING (Proposed)
	NO PARKING (Existing)
	NO PARKING (Proposed)
	UNRESTRICTED PARKING (Existing)
	UNRESTRICTED PARKING (Proposed)
	P5 MINUTE PARKING (Existing)
	P5 MINUTE PARKING (Proposed)
	P15 MINUTE PARKING (Existing)
	P15 MINUTE PARKING (Proposed)
	1/4P PARKING (Existing)
	1/4P PARKING (Proposed)
	2P/4P PARKING (Existing)
	2P/4P PARKING (Proposed)
	NO PARKING AUTHORISED CAR SHARE VEHICLES EXCEPTED (Existing)
	NO PARKING AUTHORISED CAR SHARE VEHICLES EXCEPTED (Proposed)
	BUS ZONE (Existing)
	BUS ZONE (Proposed)
	MAIL ZONE (Existing)
	MAIL ZONE (Proposed)

